



How Do You Tie Up a Spaceship in Space?

Do each exercise and find your answer in the rectangle below. Cross out the box that contains your answer. When you finish, write the letters from the remaining boxes in the spaces at the bottom of the page.

①
$$\begin{array}{r} 3.8 \\ \times 0.6 \\ \hline 2.28 \end{array}$$

②
$$\begin{array}{r} 0.92 \\ \times 0.7 \\ \hline 0.644 \end{array}$$

③
$$\begin{array}{r} 47.8 \\ \times 0.04 \\ \hline 1.912 \end{array}$$

④
$$\begin{array}{r} 19.5 \\ \times 0.6 \\ \hline 11.7 \end{array}$$

⑤
$$\begin{array}{r} 46.93 \\ \times 0.08 \\ \hline 3.7544 \end{array}$$

⑥
$$\begin{array}{r} 7.1 \\ \times 5.3 \\ \hline 37.63 \end{array}$$

⑦
$$\begin{array}{r} 0.89 \\ \times 2.7 \\ \hline 2.403 \end{array}$$

⑧
$$\begin{array}{r} 2.04 \\ \times 0.95 \\ \hline 1.938 \end{array}$$

⑨
$$\begin{array}{r} 1.62 \\ \times 5.8 \\ \hline 9.396 \end{array}$$

⑩
$$\begin{array}{r} 376.4 \\ \times 0.007 \\ \hline 2.6348 \end{array}$$

⑪
$$\begin{array}{r} 0.825 \\ \times 18 \\ \hline 14.85 \end{array}$$

⑫
$$\begin{array}{r} 0.436 \\ \times 0.69 \\ \hline 0.30084 \end{array}$$

⑬ 0.7×0.8

⑭ 15.8×0.3

⑮ $4.5 \times \$9.72$

⑯ 0.6309×1.5

⑰ 0.9×0.999

⑱ 0.083×202

- ⑲ Sound is used to measure ocean depth. Sound travels 1.5 km per second through water. If it takes 3.7 seconds for a sound to reach the bottom of the ocean, how deep is the water?

- ⑳ A scale model of a race car is 18.2 cm long and 6.9 cm wide. Each centimeter on the model represents 0.3 m on the actual car. How long is the actual car?

YO 9.396	US 1.912	LA 0.8991	WI 4.96 m	SH 0.30084	IP 3.7544	RE 5.46 m	TH \$41.64	EY 4.74
AS 0.90115	TI 0.56	CK 2.403	HO 16.766	TR 0.8871	YA 2.28	ST 2.6348	AR 0.94635	OK 0.31114
IN 14.85	MA 11.7	NO 4.85 km	TE 5.55 km	IT 0.644	UP \$43.74	TS 9.576	PA 1.938	CE 37.63

--	--	--	--	--	--	--	--	--	--	--	--	--	--	--

How Would You Describe Wanda Farr After She Met 3 Lions Deep in the Jungle?

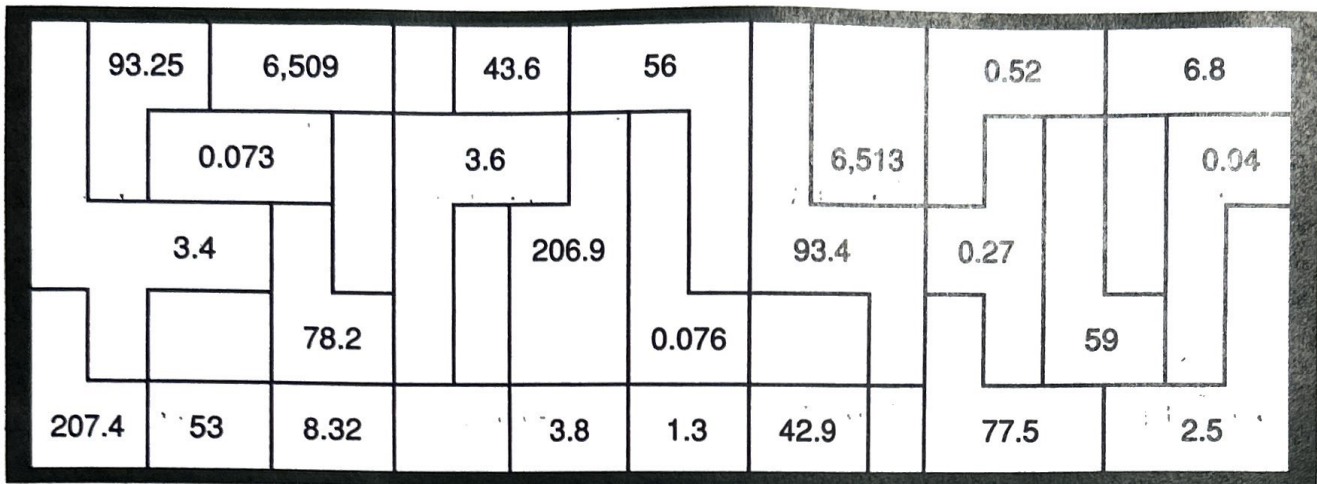

Do the exercises below and find your answers in the rectangle. Shade in each area containing a correct answer. You will discover what happened to Wanda!

① $0.4 \overline{)1.52}$ ^{3.8}

② $0.9 \overline{)0.243}$ ^{0.27}

③ $1.2 \overline{)63.6}$ ⁵³

④ $0.07 \overline{)0.476}$ ^{6.8}

⑤ $0.03 \overline{)1.287}$ ^{42.9}

⑥ $0.05 \overline{)0.416}$ ^{8.32}

⑦ $0.008 \overline{)0.62}$ ^{77.5}

⑧ $0.006 \overline{)1.2444}$ ^{207.4}

⑨ $2.08 + 1.6$

⑩ $0.1092 + 0.21$

⑪ $58.581 + 0.009$

⑫ $\frac{0.24}{0.096}$

⑬ $\frac{0.038}{0.5}$

⑭ $\frac{7.46}{0.08}$

⑮ $\frac{1.316}{32.9}$

- ⑯ A package of M&M's® candies contains 5 colors of M&M's and weighs 1.68 oz. If each candy weighs 0.03 oz, how many are in the package?

- ⑰ A machine uses 2.5 liters of fuel each hour it runs. Its fuel tank was filled with 10 L, but 1.5 L have already been used. How many more hours will the machine run?